

Assembly instructions - action cam chin mount

Mounting in the chin area of the motorcycle helmet

MiBike

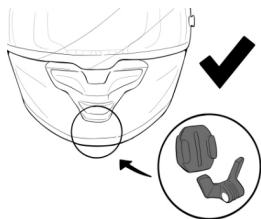

1. Our mounts are specifically designed for chin mounting – that is exactly why riders choose MiBike. Use the product photos at www.mibike.de or in our [eBay shop](#) to find the exact position on the chin area of your helmet. Before installation, check the fit on the helmet and on the Quickclip (dry fit). If anything does not fit, this is the last chance to correct it.



IMPORTANT: Mounts that have come into contact with adhesive cannot be returned or exchanged.



2. Wash your hands or use powder-free disposable gloves. The adhesive is best applied at room temperature (approx. 21 °C). Plan the installation so that the adhesive can ideally cure undisturbed for 72 hours afterwards.

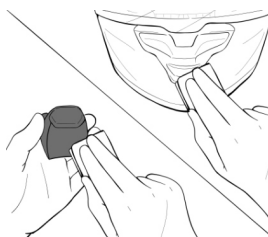

3. Thoroughly clean the adhesive surfaces on the helmet and on the mount (e.g. with isopropyl alcohol or brake cleaner). Before applying the adhesive, the surfaces must be completely dry and free of dust, grease and oil.

Note: Clean carbon helmets and smooth surfaces especially thoroughly, as residues from the manufacturing process can also reduce adhesion.

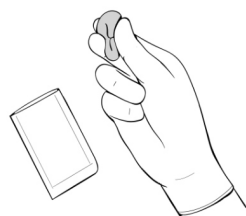

4. Open the adhesive and activate it by kneading it. The adhesive may stain slightly; this can usually be removed easily with kitchen paper and/or hand-cleaning paste. From this point on, the working time is approximately 30 minutes.



5. Apply the adhesive to the mount's bonding surfaces - only in the areas where the mount touches the helmet. Apply a little more adhesive in the middle of these areas and a thinner layer towards the edges.

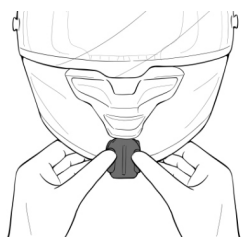

6. Position the mount, press it onto the helmet with light, even pressure and align it. The adhesive should spread right to the edges and protrude slightly on all sides of the contact area.



7. Remove any excess adhesive immediately (e.g. with a wooden spatula, toothpick, kitchen paper or by hand).



8. Allow the adhesive to cure for at least 48 hours. For best results, we recommend 72 hours of curing time and storing the helmet on a helmet cushion with the chin section facing upwards.

See how a customer did it –
scan and watch. Video in
German.



IMPORTANT: Before use, the user must check that the mount is firmly and securely attached. The user is responsible for secure attachment and safe use.

If you have any questions, you will find many answers in www.mibike.de/faq. If you still have questions after that, please feel free to write to us at info@mibike.de or contact us via the contact form or via [WhatsApp](#).

Please note: unfortunately, we cannot guarantee the bond because too many factors are beyond our control. Thank you for your understanding. If you have any questions, we will be happy to help.

Further information about the adhesive can be found in Sugru's Technical Data Sheet (TDS). It is also available at www.mibike.de/faq.

For reinstallation, please thoroughly clean the bonding surfaces and substrate, remove any old adhesive residue, and then reattach the mount. Replacement adhesive available from: www.mibike.de/product-page/kleber, www.mibike.de/product-page/kleber-alternativ-3m. If you have already used one adhesive type, we recommend sticking with it.

We really appreciate feedback, a review on [ShopVote](#) or a like on [Facebook](#) / [Instagram](#).
Have fun vlogging!

These instructions are also available in other languages: www.mibike.de/faq

By purchasing and using this mount, you waive all legal claims and claims for damages. Please ensure that you have carefully read and understood the following terms and conditions before using the mount. By using the mount, you agree to these terms and conditions and waive all claims. If you do not agree to the terms and conditions, you may return the product for a refund of the purchase price.

1. Personal responsibility for risks It is your responsibility to understand and accept all risks associated with the use of the action cam mount. This includes possible dangers that may arise from improper behaviour on your part or on the part of others. Please be aware that there are risks associated with using the mount for which you are solely responsible.

2. Health and physical fitness Before using the mount, ensure that you are physically capable of using it and that you have sufficient physical abilities to safely operate the mount and associated equipment. Ensure that using the mount does not impair your abilities and that you can use the mount safely.

3. Legal age and responsibility You must be of legal age and able to take full responsibility for using the mount. By purchasing and using the mount, you confirm that you are legally authorised to enter into contractual agreements and that you take full responsibility for using the product.

4. Safety instructions and precautions Read and understand all warnings and recommendations before using the mount.

- Be aware of weather, traffic and road conditions so that you are adequately prepared.
- Follow the safety instructions of the vehicle manufacturer and helmet manufacturer when using the mount while driving a vehicle, such as e.g. a motorbike. Always use the mount with a helmet.
- Always use the mount with extreme caution and observe all applicable traffic rules and safety regulations.

5. Legal terms and disclaimers Read and understand all legal terms and warnings related to the use of the mount. By using the mount, you agree to all terms of the disclaimer.

6. Assumption of all risks All risks associated with the use of the mount are the sole responsibility of the user, regardless of who originally purchased the product.

7. Compliance with regulations and restrictions Please note that use of the mount may violate testing standards, local or national regulations, including possible restrictions on use at racetracks or other specialised venues. You are solely responsible for the proper and safe use of the mount.

8. Secure attachment of the camera You are also responsible for ensuring that the camera is properly and securely attached to the mount before use. Check the attachment regularly to ensure that the camera is stable and securely attached during use. You are responsible for any damage or loss caused by improper attachment of the camera.

9. Data protection and personal rights When using action cameras in public spaces, data protection regulations and the rights of third parties must be observed. This means that the recordings may not be used to film people without their consent or to violate their personal rights. Please respect the privacy of other road users and passers-by.

10. Severability clause Should any provision of this agreement be or become invalid in whole or in part, this shall not affect the validity of the remaining provisions. The invalid provision shall be replaced by a valid provision that comes closest to the purpose of the invalid provision. The same applies in the event of a gap in the provisions.